

6009-2RS1

Dimensions

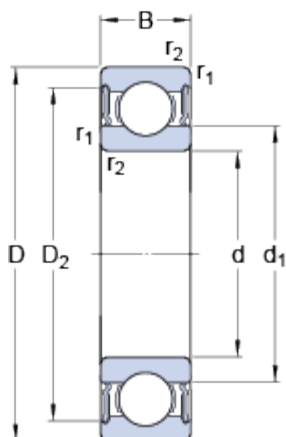

d	45	mm
D	75	mm
B	16	mm
d ₁	54.75	mm
D ₂	67.8	mm
r _{1,2}	min. 1	mm

Dimensions d'appui

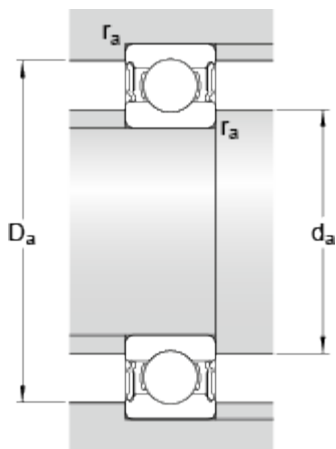

d _a	min. 50.8	mm
d _a	max. 54.7	mm
D _a	max. 69.2	mm
r _a	max. 1	mm

Données de calcul

Charge dynamique de base	C	22.1	kN
Charge statique de base	C ₀	14.6	kN
Limite de fatigue	P _u	0.64	kN
Vitesse limite		5600	r/min
Coefficient de calcul	k _r	0.025	
Coefficient de calcul	f ₀	14.9	

Masse

Masse du roulement		0.25	kg
--------------------	--	------	----